

# CUBE2, CUBE4 RECESSED SPACKLE FLANGE INSTALLATION INSTRUCTIONS

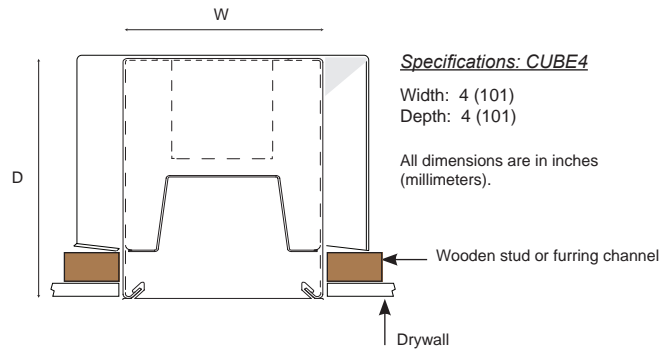

## • PART LIST

- |                       |                         |
|-----------------------|-------------------------|
| A: LED module plate   | D: Access plate         |
| B: Lens               | E: Safety bracket screw |
| C: BX cable connector | F: Safety bracket       |

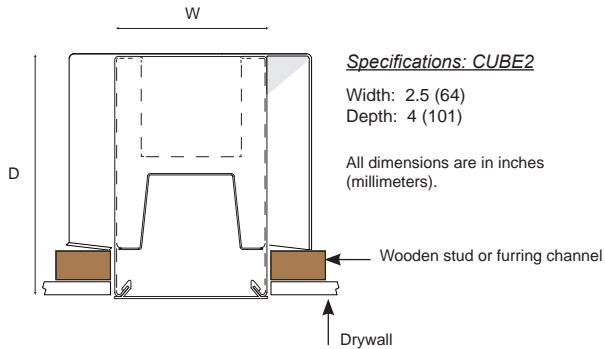
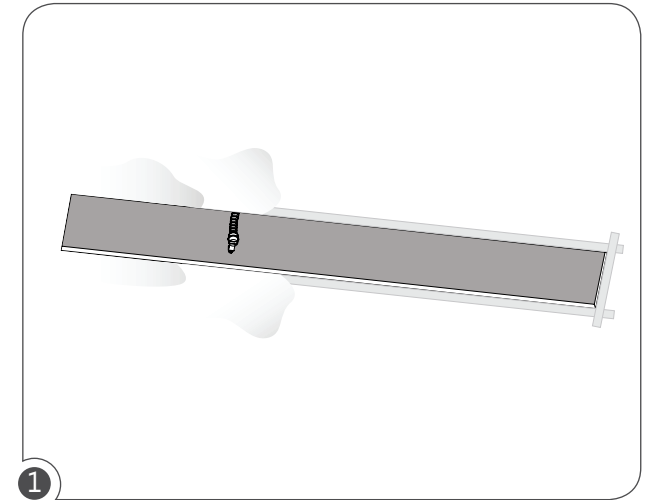

Make an opening on Drywall according to the dimensions.  
 CUBE2 (4ft) : 48-3/16" x 2-5/8", (8ft) : 96-3/16" x 2-5/8"  
 CUBE4 (4ft) : 48-3/16" x 4-1/8", (8ft) : 96-3/16" x 4-1/8"

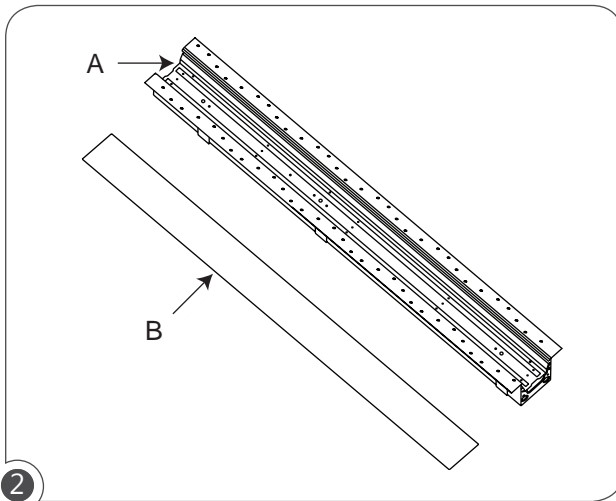

Remove Lens(B) and LED module plate(A).

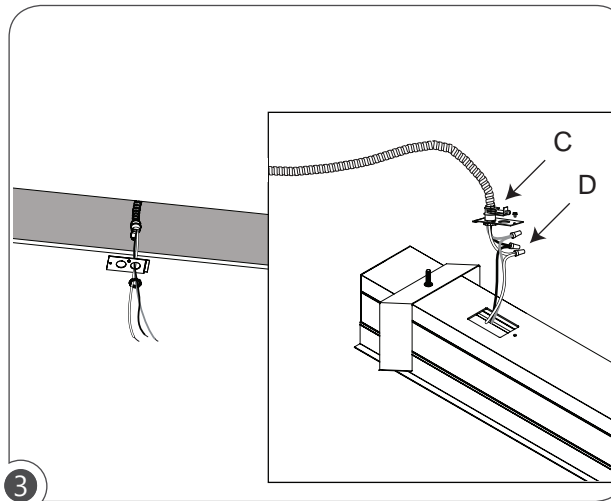

Install BX cable connector(C) to access plate(D). Wire BX cable wires to Fixture wires.

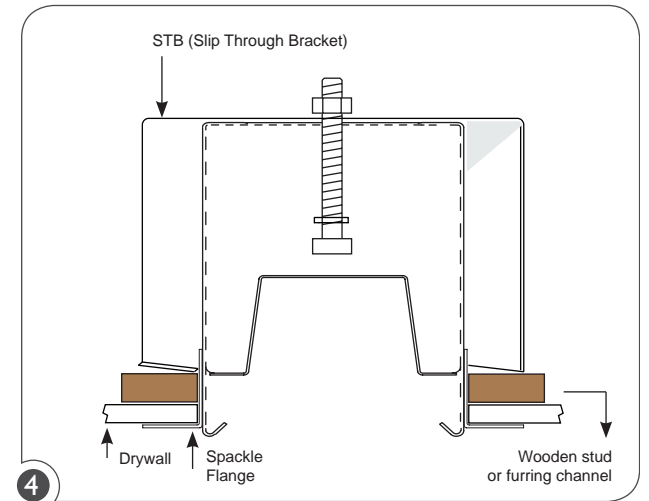

Align fixture(with slip through bracket) to pre-cut hole on drywall and insert fixture. use short wooden stud for STB.



# CUBE2, CUBE4 RECESSED SPACKLE FLANGE INSTALLATION INSTRUCTIONS

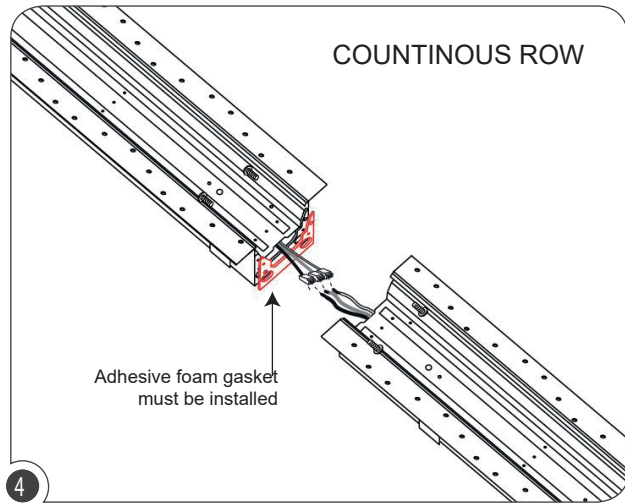

4 Refer to [4A] on the last page for detailed installation instructions.

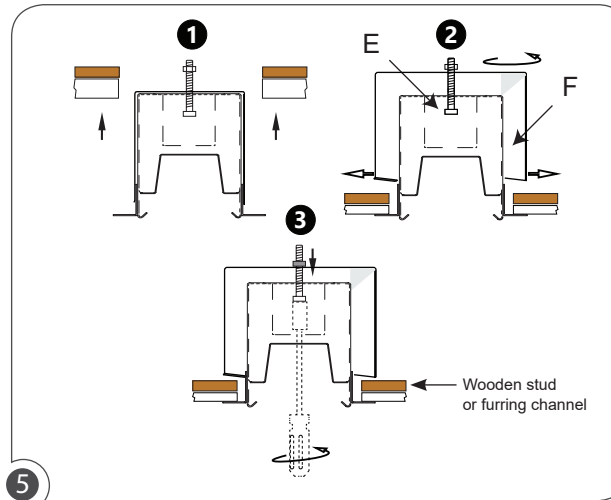

5 Push safety bracket screw(E) up to rotate safety brackets(F) once bracket is correctly align tighten screw to lock fixture in to drywall ceiling.

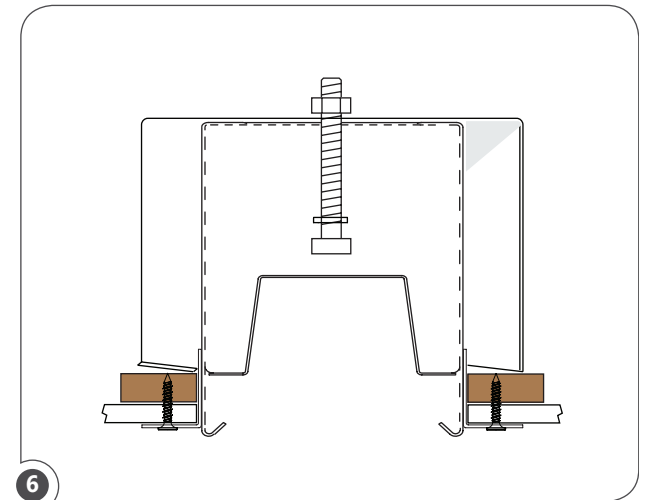

6 Wooden stud or furring channel must be used to reinforce the screws to the drywall.

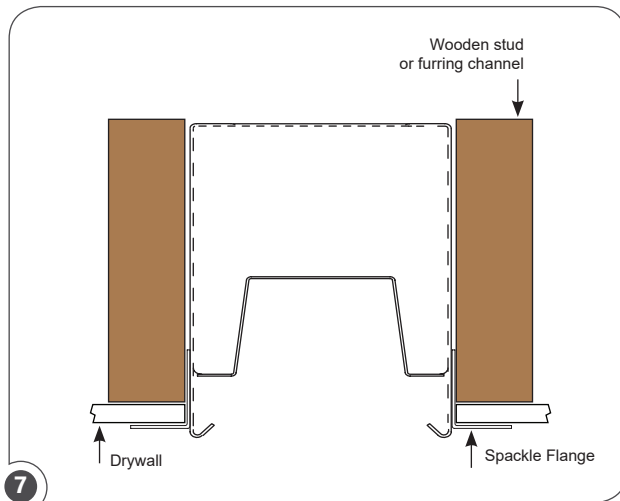

7 Align fixture(without slip through bracket) to pre-cut hole on drywall and insert fixture. use long wooden stud. (Skip this if you did 4)

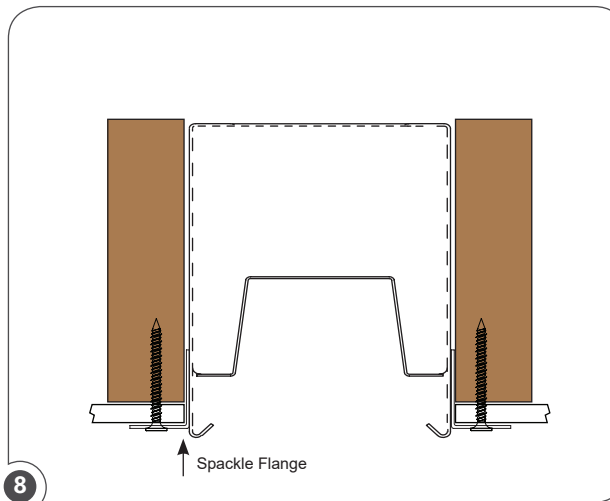

8 Wooden stud or furring channel must be used to reinforce the screws to the drywall.



# CUBE2, CUBE4 RECESSED SPACKLE FLANGE INSTALLATION INSTRUCTIONS

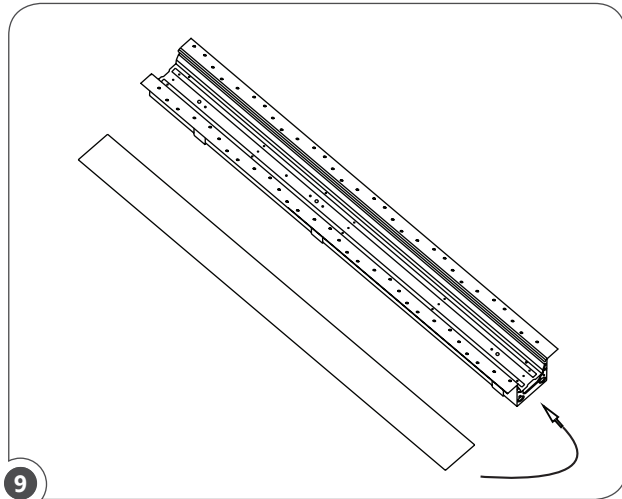

9 Reinstall LED module plate and lens.

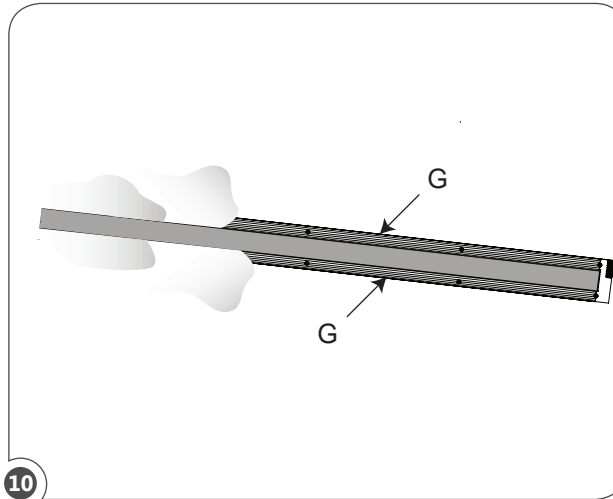

10 Unless a row installation is needed, plaster and sand over spackle flange (G) to create a smooth finish.

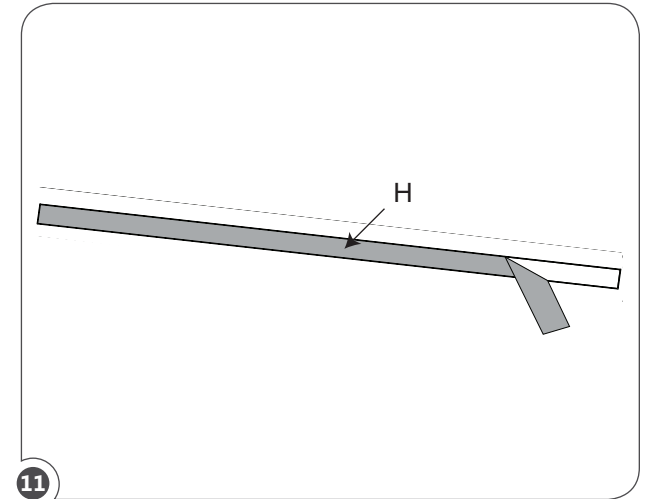

11 Remove blue tape from lens (H) BEFORE last plaster layer is fully dry.

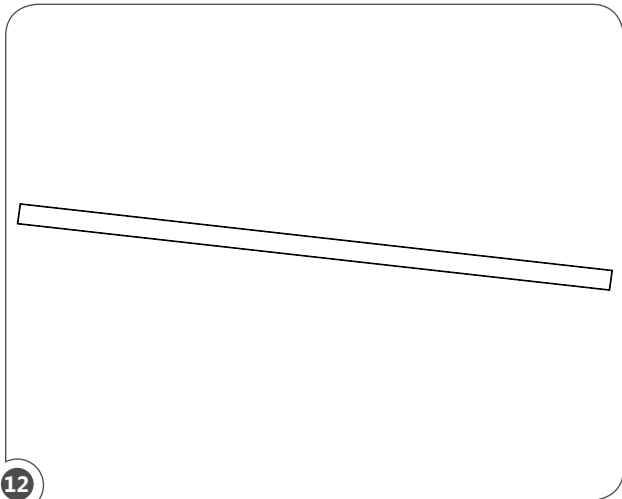

12 It is now safe to turn the fixture's circuit on.



# CUBE2, CUBE4 RECESSED SPACKLE FLANGE INSTALLATION INSTRUCTIONS

## CONTINUOUS ROW

### TOOL(S) NEEDED:

Option 1) Cordless drill and an elbow or L-shape adapter with Philips Insert Bit extension.

Option 2) Flexible Screwdriver with Philips Insert Bit.

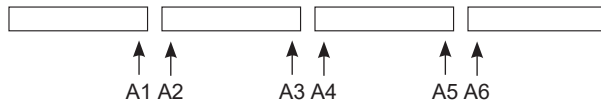

### Continuous Row

Align continuous row fixtures in numerical order under the same alphabet family.

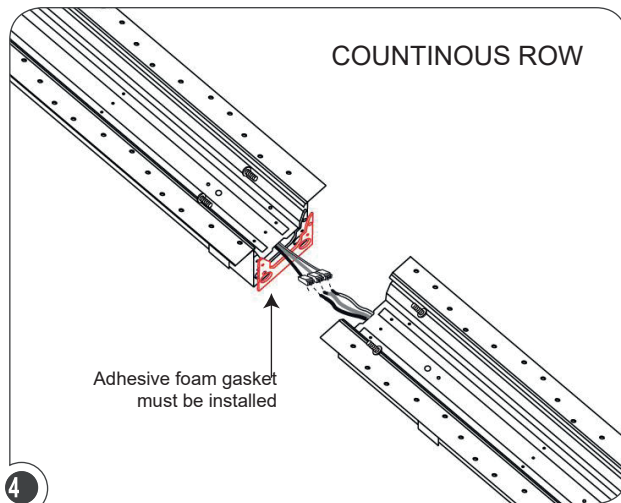

- 1) Make wiring connection from each fixture power supply wires together.
- 2) Align fixtures and screw together with 4 screws(H).

**WARNING:**



RISK OF FIRE AND ELECTRICAL SHOCK. FIXTURE MUST BE INSTALLED BY A QUALIFIED ELECTRICIAN ONLY IN ACCORDANCE WITH NATIONAL, LOCAL BUILDING AND ELECTRICAL CODES. DISCONNECT POWER AT ELECTRICAL PANEL BEFORE SERVICING.